

POSITIONING & INSTALLATION

SAPIENSTONE

POSITIONING



Handling after cutting

After completing all work on large format ceramics, take special care during handling, transport and installation at the client's premises.

Most damage to the structure occurs during these phases, caused by flexing, twisting or impact on edges and corners. When there are large cutouts, or more than one cutout, we recommend installing wooden bars (50 x 30 mm/1.2"x2.0") along the entire length of the large format ceramic and also crossways, as per the diagram below to reduce the possibility of flexing (using hot glue to fix in place).

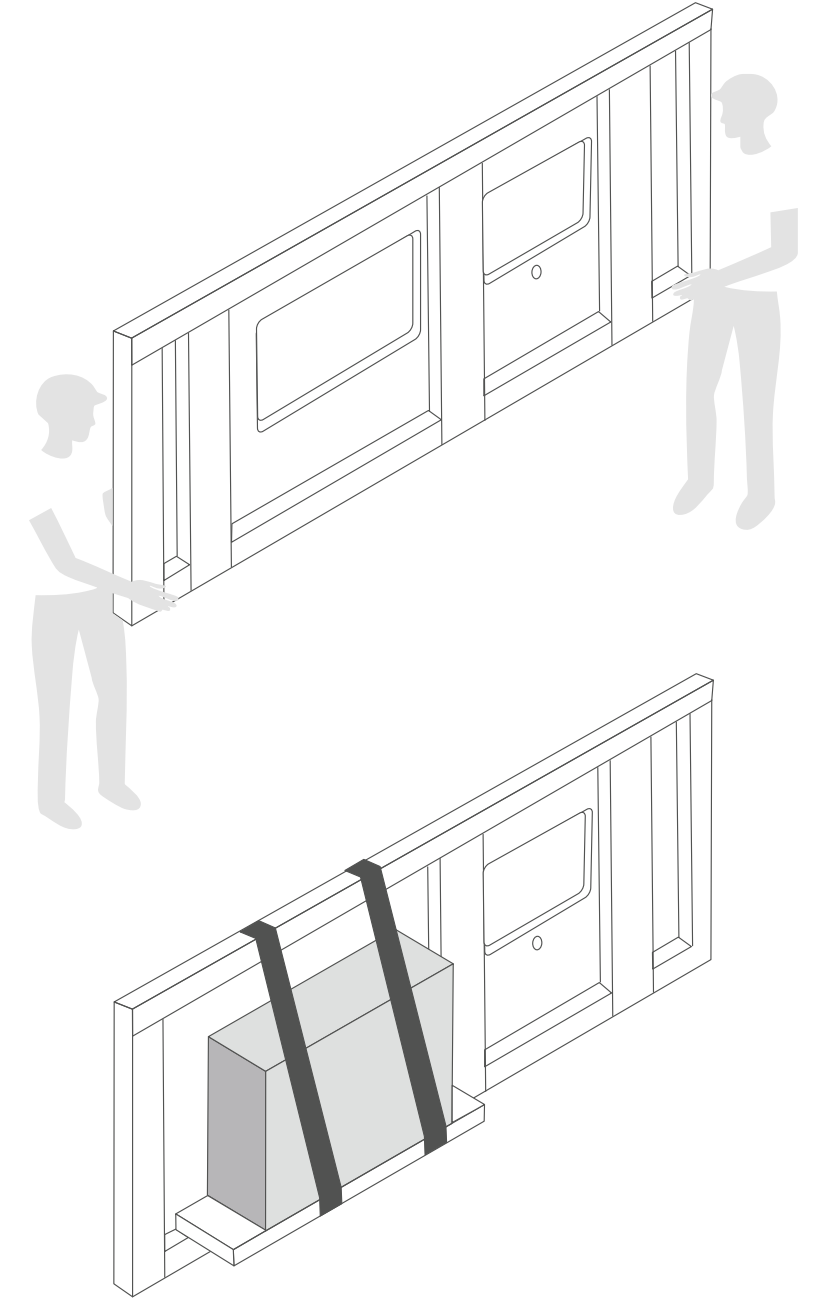

If the kitchen counter has a built-in basin assembled directly on the large format ceramic, provide support and fix the basin so that it cannot cause twisting or flexing.

Approaching the pieces

While approaching the slabs we recommend to follow the procedure below to guarantee the best possible positioning:

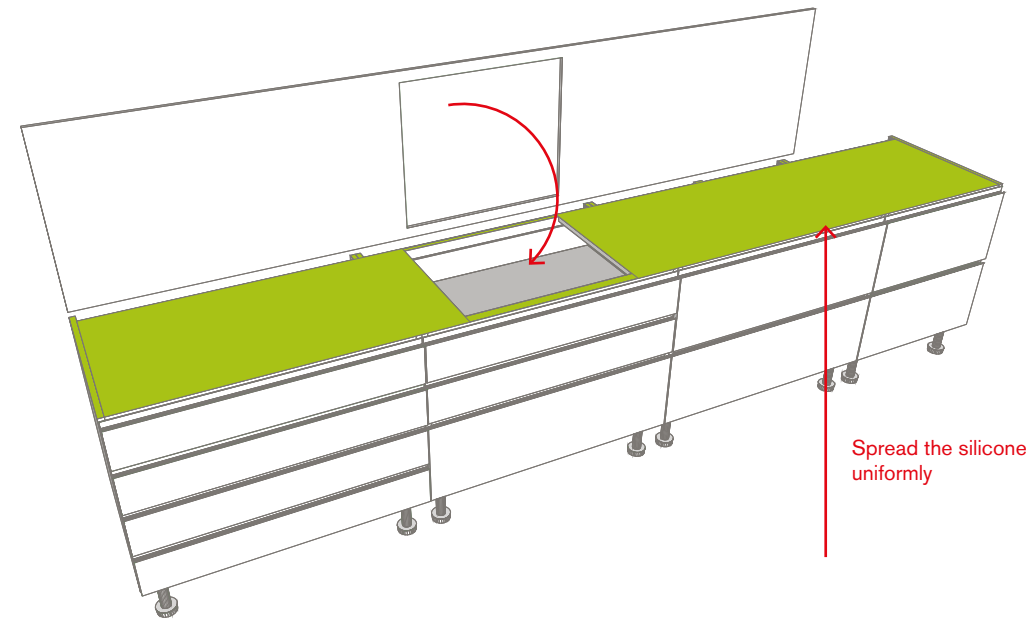

Positioning the pieces without joint

Please handle the slabs carefully, with special caution to edges and keeping to the instructions below for their positioning:

1. check that each edge is minimally chamfered to make the slab more solid;
2. make sure that the substrate is levelled and perfectly flat, otherwise adjust or adapt using levelling wedges;
3. check that the joint edges match perfectly and do not have different angles, which may cause breakage.

Levelling wedges must be inserted while approaching two adjacent slabs to avoid any impact.
The wedges can be removed only when silicone is applied and during possible later final adjustments that require a min. movement.

Positioning the reinforcements

It is recommended to build reinforcements to be placed on the slab rear side at a reciprocal distance of 600 mm (24.0 in).
All joints must be reinforced in the lower part.
Gaps, not supported by any surface, must be reinforced with bars of a sufficiently resistant material, such as: granite, aluminum, high density polyurethane foam.

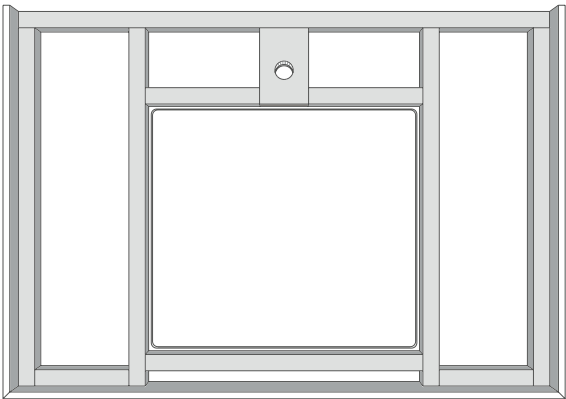

If the taps are to be installed directly in the top, it is advisable to add a reinforcing pad under the top in the point where the hole has been drilled. Be careful as the pad must be positioned so as to enable free movements of the top.

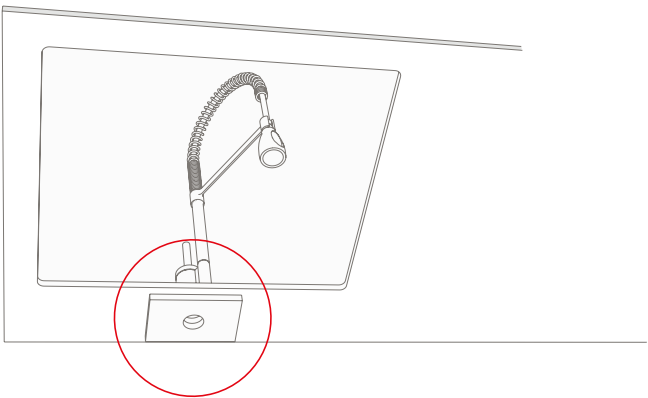



Countertop support substructure

Before installing the top ensure that all parts of the cabinet structure are stable, level, clean and are able to support the load.

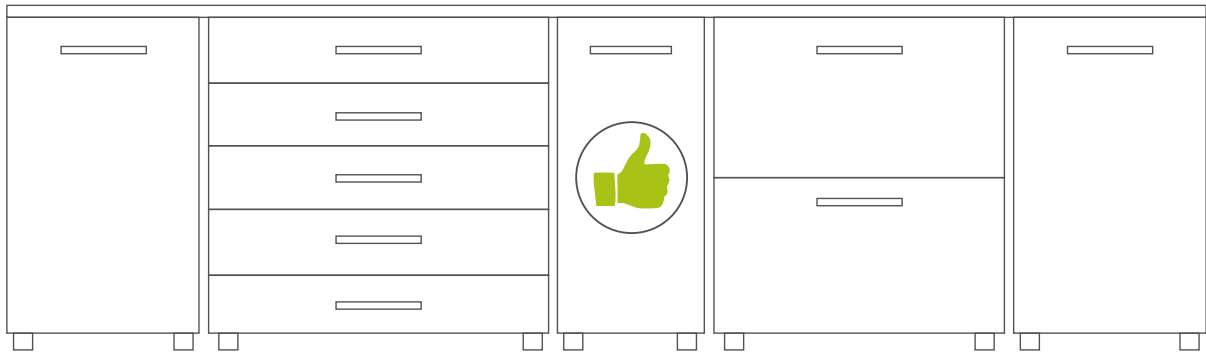
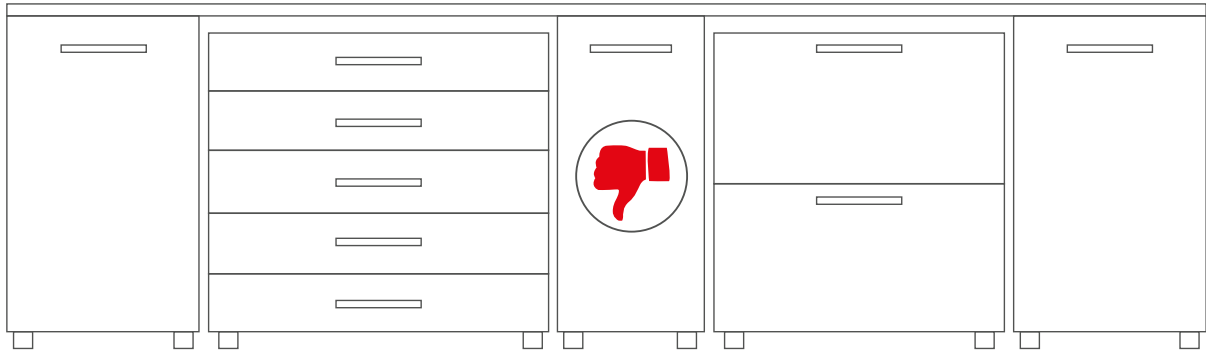

Over time the structure may settle slightly. We therefore recommend periodically checking the level of the cabinet supporting the top, and adjusting the feet usually provided on the base of the cabinet.

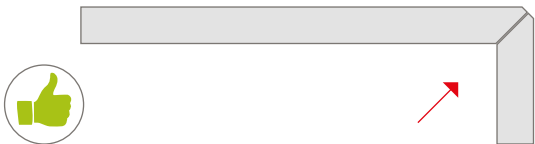
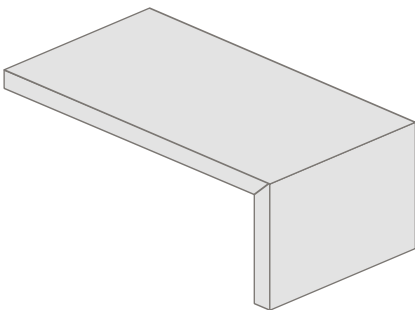
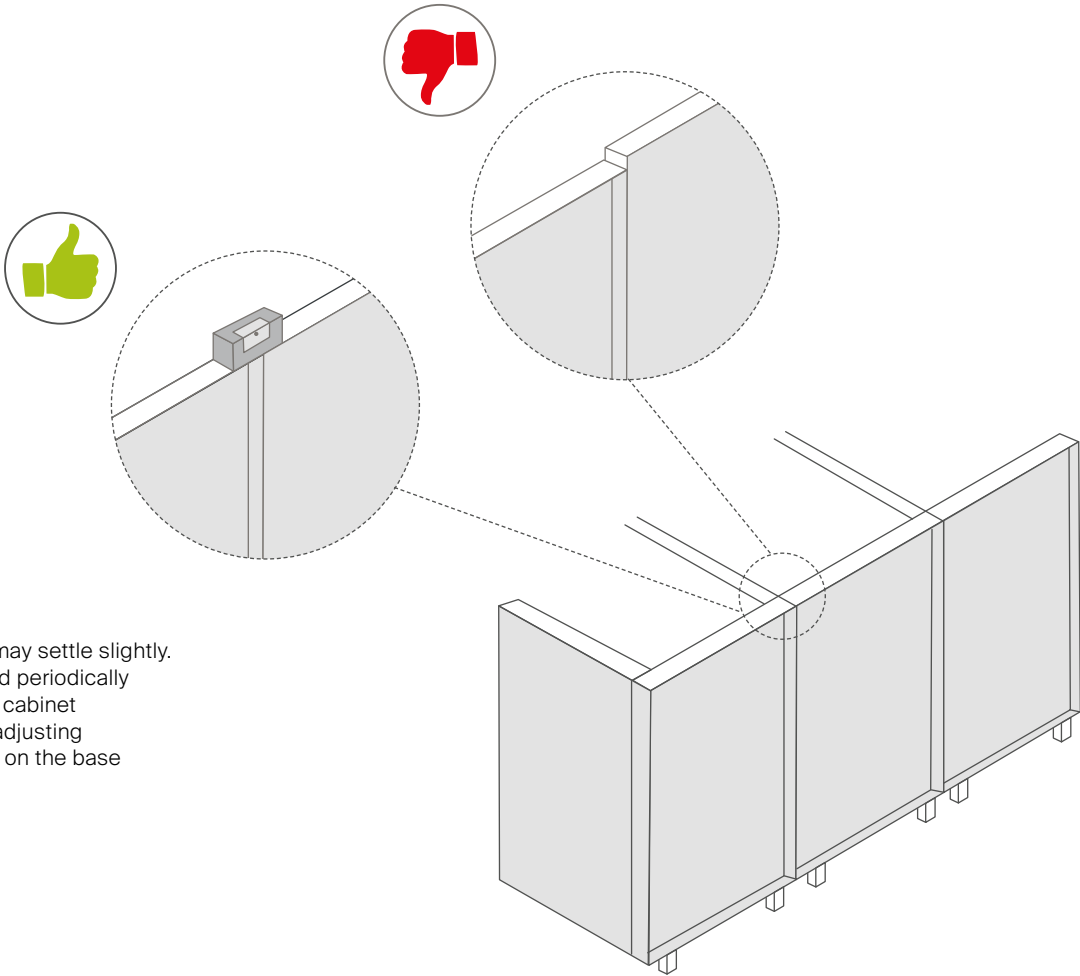

Bonding the top

To bond porcelain stoneware parts (i.e. joints between vertical and horizontal pieces), use a two-part epoxy resin in the same color as the ceramics. Remove any excess two-part resin before it hardens.

To bond the top to the structure use an flexible adhesive (i.e. silicone). For joints between set-in elements and the top use a transparent flexible adhesive (i.e. silicone) or the gaskets supplied with the basin or appliance.

INSTALLING THE KITCHEN TOP

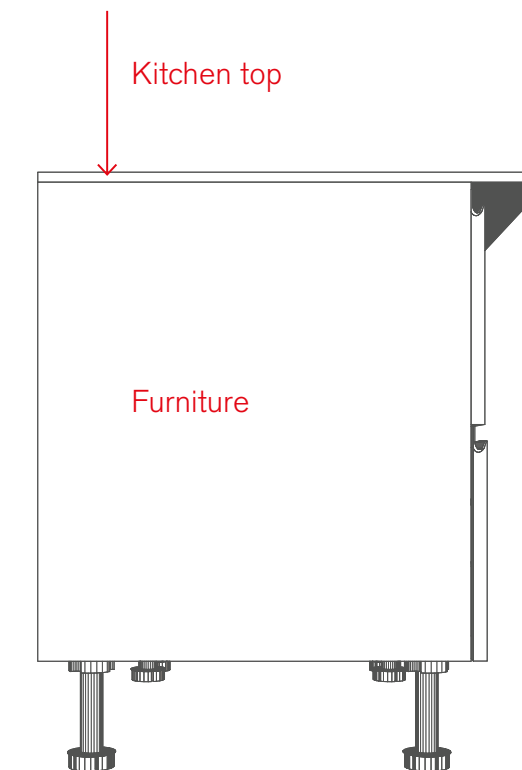

Installing the kitchen top

We always recommend to position an insulating panel over the dishwasher or under the worktop.

All tops and islands made with 12 mm (0.48 in) slabs can be installed with a projection. We also recommend to make a 3-4 mm (0.12 / 0.16 in) radius around the slab edges.

It is recommended to position a supporting strip under the points where the 12 mm (0.48 in) slabs are matched in 50 mm (2.0 in) wide laminar structures and to make sure that the strip has the same thickness.

Sapienstone reserves the right to modify technical and formal details included in this catalogue. Colors reproductions are approximate. All rights are reserved. Total or partial reproduction of text or illustrations of this catalogue is prohibited and is subject to legal sanctions.



Sapienstone
Via Guido Reni, 2
42014 Castellarano (RE) Italy
T +39 0536 816883
info@sapienstone.com

sapienstone.com





SAPIENSTONE